

# UNDERBODY CLAMP

# XPCR63

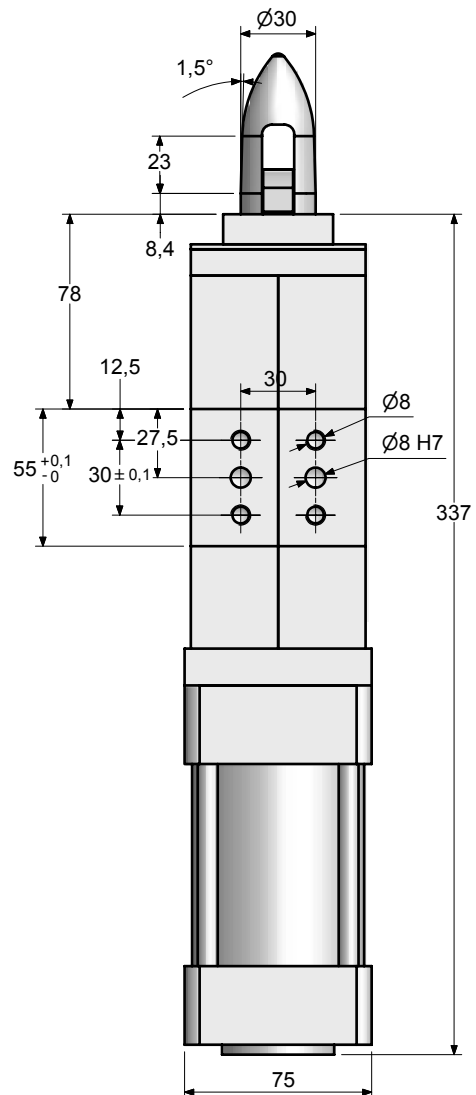

Jaguar X152 Underbody  
Claw Clamp. 30mm Dia  
Pin. Wedge Action,  
Integrated Sensing.

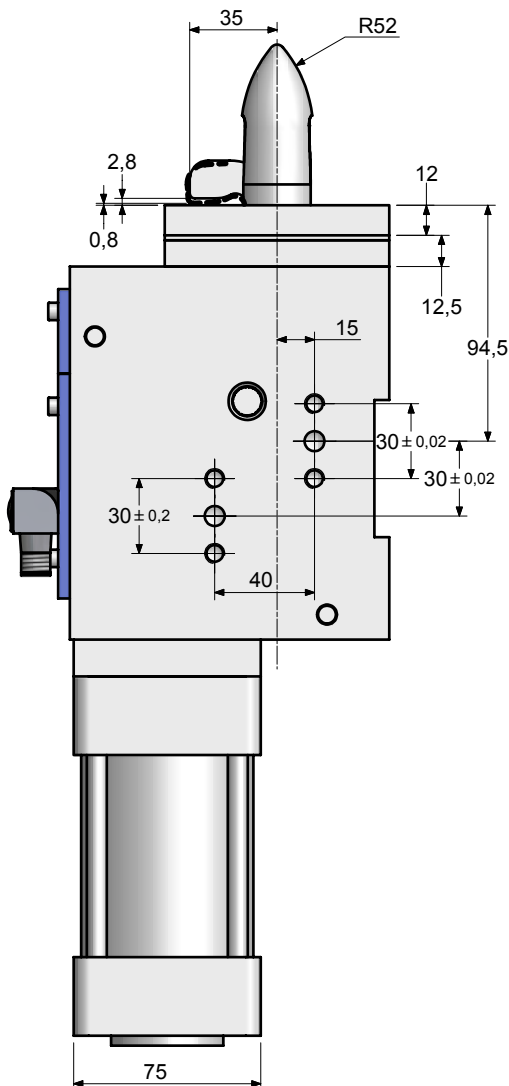
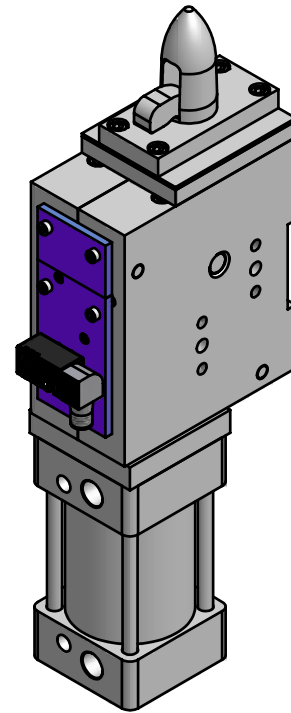
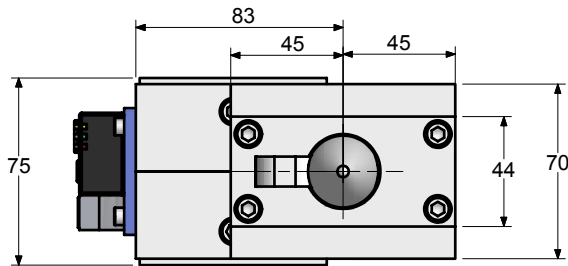

# UNDERBODY CLAMP

# XPCR63



**Underbody Claw Clamp.**  
**30mm Dia pin. Wedge action,**  
**Nonlocking,**  
**Intergrated sensing.**

Maximum air pressure 8 BAR  
 Normal working 5 BAR  
 Dry air is permissible  
 Restrictors must be used in conjunction with cylinder

**Sensing options**  
 NS No sensing  
 ES1 Inductive switches

**Weight 11.00Kg**

**Order code:**

**XPCR63-ES1-30-500-X01**  
 (30mm pin, panel gap 5.0mm)

**XPCR63-ES1-F29-500-X01**  
 (30mm pin, 29mm flats, panel gap 5.0mm)

### Pull Down Allowance

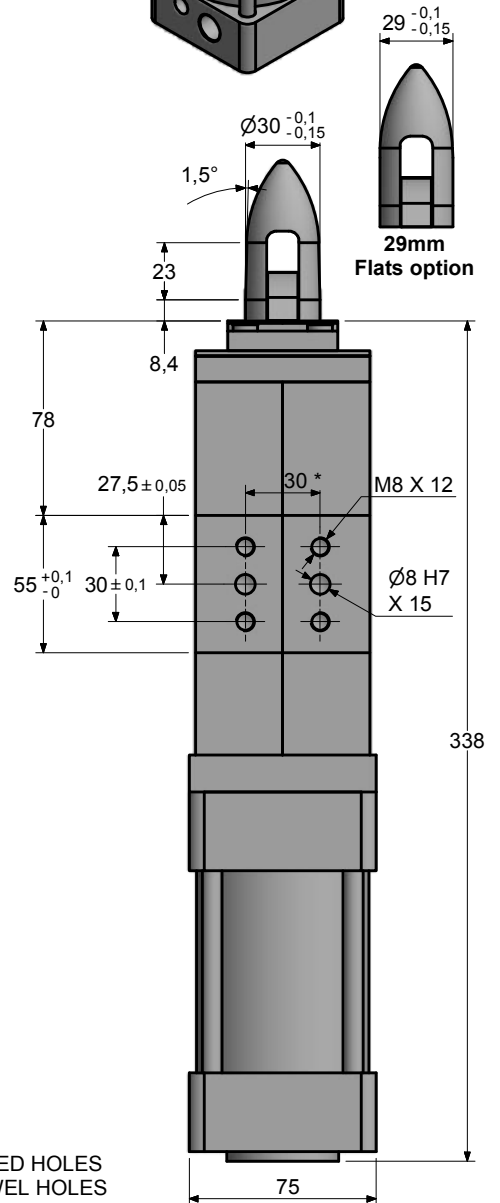
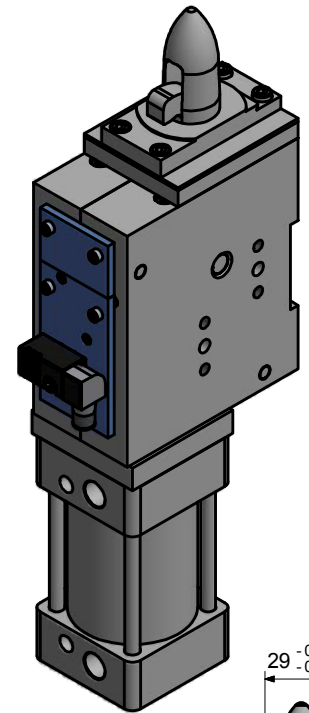
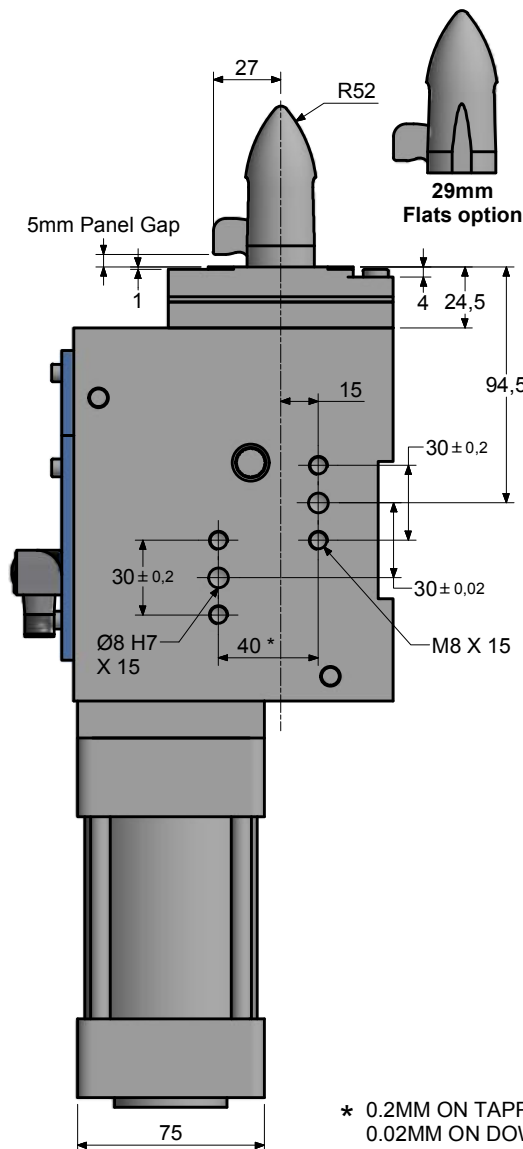
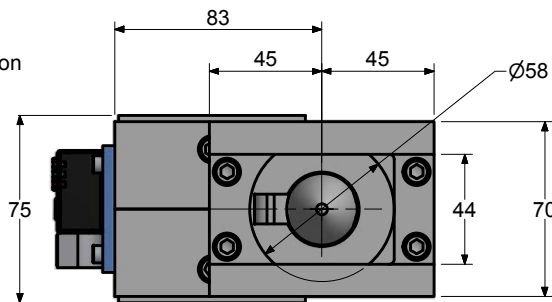
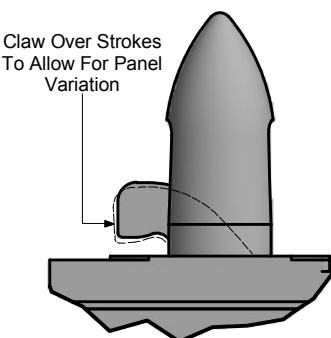
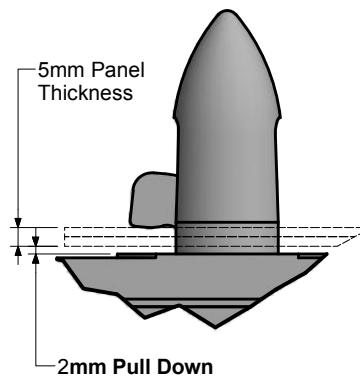

\* 0.2MM ON TAPPED HOLES  
 0.02MM ON DOWEL HOLES